



TV Safety Straps + Clamp Installation Guide

General:

When anchoring to wall, always mount to the center of a solid wall stud. Studs are usually on 16" centers. When attaching to furniture, use a solid wood surface to secure screws. Always drill pilot holes in furniture and wall studs before anchoring screws. **Installation of anti-tip straps does not replace the need for adult supervision. Never let children play with or climb on TV or furniture. (Please)**

Recommended Tools:

Phillips screwdriver, ruler, drill and pencil. Also recommended: electronic stud finder.

To Install TV to Wall:

1. Locate upper VESA mounting holes on back of flat screen TV and select the correct included bolt size to fit TV. Washers are only required (and included) for the smallest bolt size.
2. Once correct bolts have been selected, install Buckle 1 to the VESA mounting holes on TV. Bolt should be mounted through the large center hole and tightened into VESA mounting hole. Repeat for both sides of TV, 1 strap per side (2 straps total).
3. Using stud finder, locate wall studs behind the TV and mark them approximately 6" below the height of the position of the plate attached to the TV. Mount Buckle 2 of each strap to a separate stud using the 1" screws provided. It is necessary to pre-drill a pilot holes.
4. Tighten each strap by pulling free end of webbing until there is no slack.

To Install TV to Furniture:

1. Locate upper VESA mounting holes on back of flat screen TV and select the correct included bolt size to fit TV. Washers are only required (and included) for the smallest bolt size.
2. Once correct bolts have been selected, install Buckle 1 to the VESA mounting holes on TV. Bolt should be mounted through the large center hole and tightened into VESA mounting hole. Repeat for both sides of TV, 1 strap per side (2 straps total).

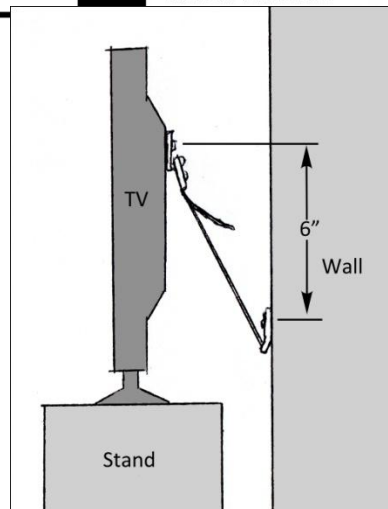
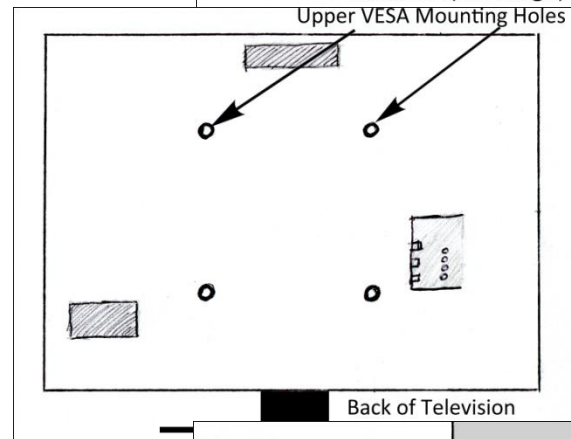
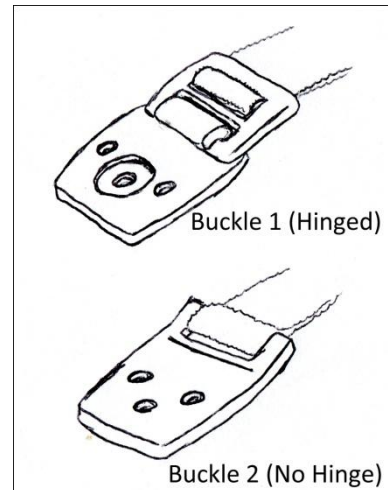

TV Safety Straps +Clamp Installation Guide

Product: MB1606

Saignus LLC

(931) 548-6383

www.MunchyBaby.com

www.facebook.com/munchybabyproducts

www.pinterest.com/munchybaby

Sign up here
for a \$2.00
discount on
your next purchase
from Munchy Baby!





3. Extend both straps downward towards the TV stand. If using the clamp assembly, slip clamp hook into strap loop attaching Buckle 2 for each strap assembly. If not using the clamp assembly, attach the Buckle 2 to stand for each strap using the 1" screws provided. It is necessary to pre-drill pilot holes.
4. Tighten each strap by pulling free end of webbing until there is no slack.
5. If you have a free-standing TV stand, it should be secured to the wall per the instructions below.

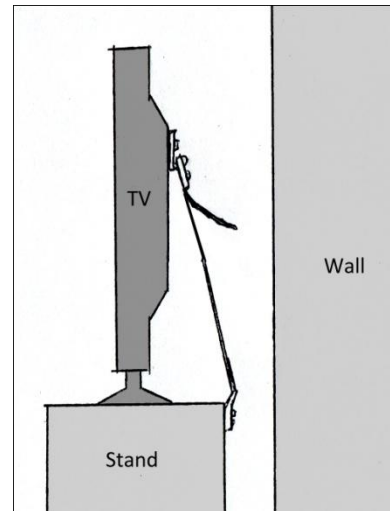
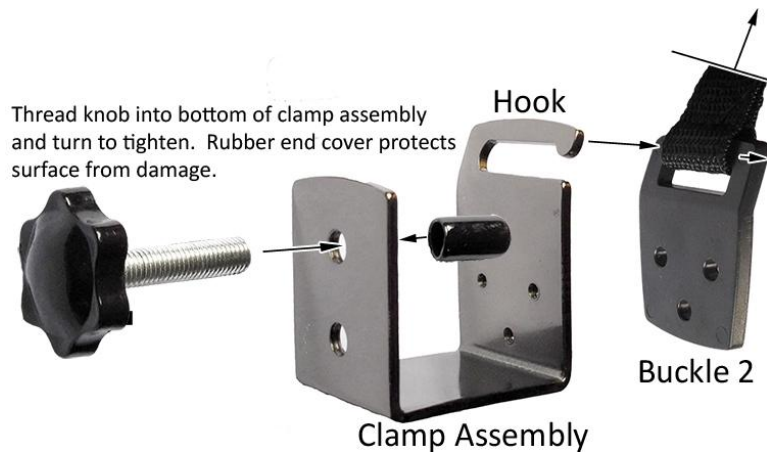

To Install Furniture to Wall:

1. Locate center of wall studs behind furniture. Mark stud locations on wall at top of furniture. Use two straps per piece of furniture when possible. Each strap should be mounted to a different stud.
2. Slide furniture item away from wall.
3. Drill a pilot hole into the wall studs about 6"-8" below the top of furniture.
4. Attach Buckle 1 to the wall stud with the 2 1/2" screw and 1" screws provided.
5. Using 1" screws, attach Buckle 2 of each strap to the top of furniture for tall pieces of furniture (i. e. bookcases), or to the back of furniture for lower pieces (i. e. dressers). Attach where wood is at least 3/4" thick. Do not install 2 1/2" screw into wooden surface so that it protrudes from the other side of the surface.
6. Slide furniture back into position and tighten each strap by pulling upward. Pull free end of webbing until there is no slack.

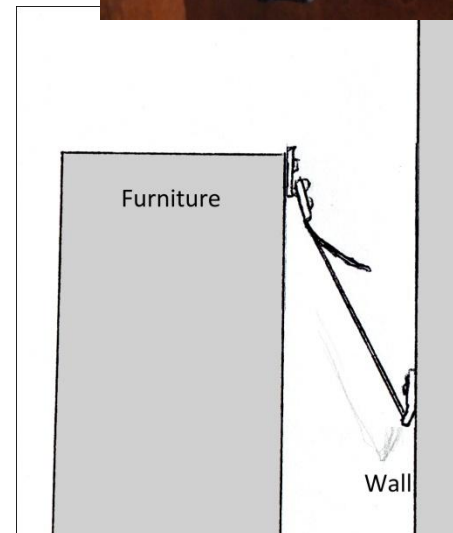

TV Safety Straps +Clamp Installation Guide

Product: MB1606

Saignus LLC

(931) 548-6383

www.MunchyBaby.com

www.facebook.com/munchybabyproducts

www.pinterest.com/munchybaby

Sign up here
for a \$2.00
discount on
your next purchase
from Munchy Baby!

